

2N3740 2N3740A
2N3741 2N3741A

**SILICON
PNP POWER TRANSISTORS**



TO-66 CASE

MAXIMUM RATINGS: ($T_C=25^\circ\text{C}$)

Collector-Base Voltage
Collector-Emitter Voltage
Emitter-Base Voltage
Continuous Collector Current
Peak Collector Current
Continuous Base Current
Power Dissipation
Operating and Storage Junction Temperature

SYMBOL	2N3740	2N3741	UNITS
	2N3740A	2N3741A	
V_{CBO}	60	80	V
V_{CEO}	60	80	V
V_{EBO}		7.0	V
I_C		4.0	A
I_{CM}		10	A
I_B		2.0	A
P_D		25	W
T_J, T_{stg}		-65 to +200	$^\circ\text{C}$

ELECTRICAL CHARACTERISTICS: ($T_C=25^\circ\text{C}$ unless otherwise noted)

SYMBOL	TEST CONDITIONS	MIN	MAX	UNITS
I_{CEV}	$V_{CE}=\text{Rated } V_{CEO}, V_{BE}=1.5\text{V}$ (2N3740, 2N3741)		100	μA
I_{CEV}	$V_{CE}=\text{Rated } V_{CEO}, V_{BE}=1.5\text{V}$ (2N3740A, 2N3741A)		100	nA
I_{CEV}	$V_{CE}=40\text{V}, V_{BE}=1.5\text{V}, T_C=150^\circ\text{C}$ (2N3740)		1.0	mA
I_{CEV}	$V_{CE}=40\text{V}, V_{BE}=1.5\text{V}, T_C=150^\circ\text{C}$ (2N3740A)		0.5	mA
I_{CEV}	$V_{CE}=60\text{V}, V_{BE}=1.5\text{V}, T_C=150^\circ\text{C}$ (2N3741)		1.0	mA
I_{CEV}	$V_{CE}=60\text{V}, V_{BE}=1.5\text{V}, T_C=150^\circ\text{C}$ (2N3741A)		0.5	mA
I_{CBO}	$V_{CB}=\text{Rated } V_{CBO}$ (2N3740, 2N3741)		100	μA
I_{CBO}	$V_{CB}=\text{Rated } V_{CBO}$ (2N3740A, 2N3741A)		100	nA
I_{CEO}	$V_{CE}=40\text{V}$ (2N3740)		1.0	mA
I_{CEO}	$V_{CE}=40\text{V}$ (2N3740A)		1.0	μA
I_{CEO}	$V_{CE}=60\text{V}$ (2N3741)		1.0	mA
I_{CEO}	$V_{CE}=60\text{V}$ (2N3741A)		1.0	μA
I_{EBO}	$V_{EB}=7.0\text{V}$ (2N3740, 2N3741)		0.5	mA
I_{EBO}	$V_{EB}=7.0\text{V}$ (2N3740A, 2N3741A)		100	nA
BV_{CEO}	$I_C=100\text{mA}$ (2N3740, 2N3740A)	60		V
BV_{CEO}	$I_C=100\text{mA}$ (2N3741, 2N3741A)	80		V
$V_{CE(SAT)}$	$I_C=1.0\text{A}, I_B=125\text{mA}$		0.6	V
$V_{BE(ON)}$	$V_{CE}=1.0\text{V}, I_C=250\text{mA}$		1.0	V
h_{FE}	$V_{CE}=1.0\text{V}, I_C=100\text{mA}$	40		
h_{FE}	$V_{CE}=1.0\text{V}, I_C=250\text{mA}$	30	200	
h_{FE}	$V_{CE}=1.0\text{V}, I_C=500\text{mA}$	20		
h_{FE}	$V_{CE}=1.0\text{V}, I_C=1.0\text{A}$	10		
h_{fe}	$V_{CE}=10\text{V}, I_C=50\text{mA}, f=1.0\text{kHz}$	25		
f_T	$V_{CE}=10\text{V}, I_C=100\text{mA}, f=1.0\text{MHz}$	4.0		MHz
C_{ob}	$V_{CB}=10\text{V}, I_E=0, f=100\text{kHz}$		100	pF

www.centrasemi.com

DESCRIPTION:

The CENTRAL SEMICONDUCTOR 2N3740 series devices are silicon PNP power transistors manufactured by the epitaxial base process designed for power amplifier and medium speed switching applications.

MARKING: FULL PART NUMBER

R2 (2-September 2014)

2N3740 2N3740A
 2N3741 2N3741A

SILICON
 PNP POWER TRANSISTORS



TO-66 CASE - MECHANICAL OUTLINE

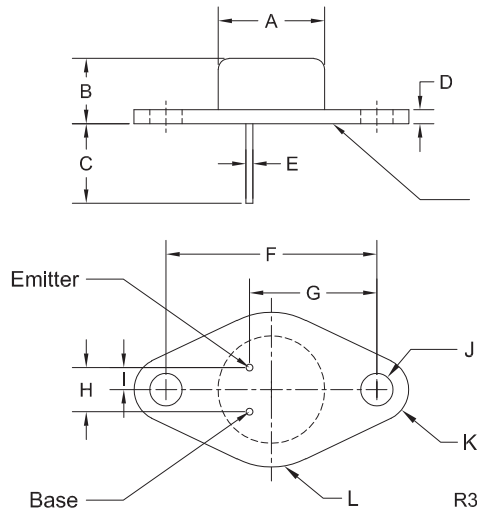

MARKING:
 FULL PART NUMBER

SYMBOL	DIMENSIONS			
	INCHES		MILLIMETERS	
	MIN	MAX	MIN	MAX
A (DIA)	0.470	0.500	11.94	12.70
B	0.250	0.340	6.35	8.64
C	0.360	-	9.14	-
D	0.050	0.075	1.27	1.91
E (DIA)	0.028	0.034	0.71	0.86
F	0.956	0.964	24.28	24.48
G	0.570	0.590	14.48	14.99
H	0.190	0.210	4.83	5.33
I	0.093	0.107	2.36	2.72
J (DIA)	0.142	0.152	3.61	3.86
K (RAD)	0.141		3.58	
L (RAD)	0.345		8.76	

TO-66 (REV:R3)

R2 (2-September 2014)

OUTSTANDING SUPPORT AND SUPERIOR SERVICES



PRODUCT SUPPORT

Central's operations team provides the highest level of support to insure product is delivered on-time.

- Supply management (Customer portals)
- Inventory bonding
- Consolidated shipping options
- Custom bar coding for shipments
- Custom product packing

DESIGNER SUPPORT/SERVICES

Central's applications engineering team is ready to discuss your design challenges. Just ask.

- Free quick ship samples (2nd day air)
- Online technical data and parametric search
- SPICE models
- Custom electrical curves
- Environmental regulation compliance
- Customer specific screening
- Up-screening capabilities
- Special wafer diffusions
- PbSn plating options
- Package details
- Application notes
- Application and design sample kits
- Custom product and package development

REQUESTING PRODUCT PLATING

1. If requesting Tin/Lead plated devices, add the suffix "TIN/LEAD" to the part number when ordering (example: 2N2222A TIN/LEAD).
2. If requesting Lead (Pb) Free plated devices, add the suffix "PBFREE" to the part number when ordering (example: 2N2222A PBFREE).

CONTACT US

Corporate Headquarters & Customer Support Team

Central Semiconductor Corp.
145 Adams Avenue
Hauppauge, NY 11788 USA
Main Tel: (631) 435-1110
Main Fax: (631) 435-1824
Support Team Fax: (631) 435-3388
www.centrasemi.com

Worldwide Field Representatives:
www.centrasemi.com/wwreps

Worldwide Distributors:
www.centrasemi.com/wwdistributors

For the latest version of Central Semiconductor's **LIMITATIONS AND DAMAGES DISCLAIMER**, which is part of Central's Standard Terms and Conditions of sale, visit: www.centrasemi.com/terms

Mouser Electronics

Authorized Distributor

Click to View Pricing, Inventory, Delivery & Lifecycle Information:

[Central Semiconductor:](#)

[2N3740](#) [2N3741](#) [2N3741A](#)