

Recommended P.C.B. Layout
PCB Thickness:1.6mm

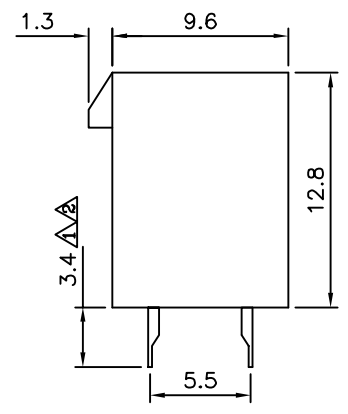
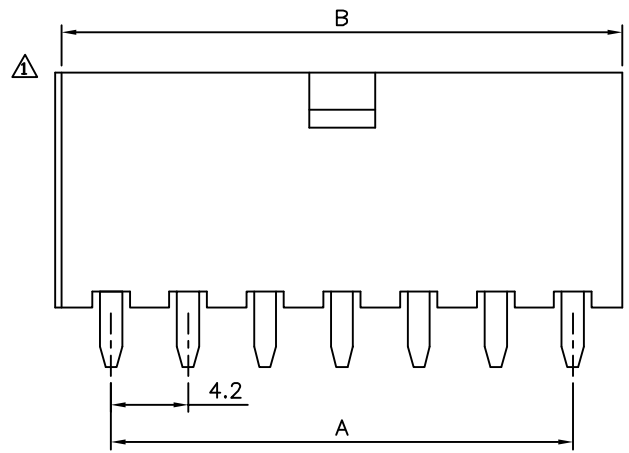
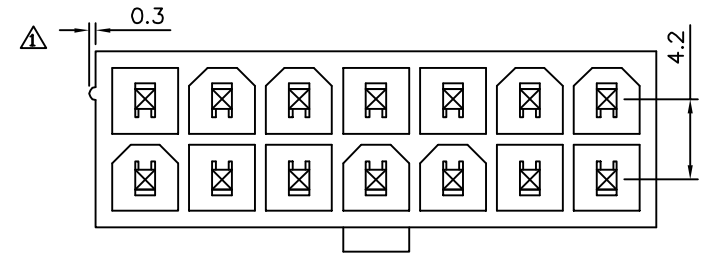

△ SPECIFICATION

- Current Rating:7A AC/DC
- Voltage Rating:250V AC/DC
- Withstand Voltage:1500V AC/Minute
- Insulation Resistance:1000 Megaohms Min.
- Temperature Range:-25°C~+85°C
- Insulator:PA66(UL94V-2)
- △ Contact:Brass,Tin Plated Over Nickel
- RoHS Compliant

Pin	A	B
02	—	5.2
04	4.20	9.4
06	8.40	13.6
08	12.60	17.8
10	16.80	22.0
12	21.00	26.2
14	25.20	30.4
16	29.40	34.6
18	33.60	38.8
20	37.80	43.0
22	42.00	47.2
24	46.20	51.4



DRAWING No.		APPROVED BY		UNLESS OTHERWISE SPECIFIED TOLERANCES ARE .X ±0.38 .XX ±0.25 ANG.
02256		EMILY		
		CHECKED BY		
		HZF		
		DRAWING BY		
		GAO		
SCALE	NONE	REV.	A2	UNIT
				mm

NO.	REV.	REVISIONS	CHK	DATE
△ A2		Modify Data	HZF	08/02/2013
△ A1		Modify Data	HZF	10/20/2009
△ A0		NEW RELEASE		