

**△ SPECIFICATION**  
 Current Rating: 3A AC/DC  
 Voltage Rating: 250V AC Max.  
 Operation Temperature: -25°C~+85°C  
 Contact Resistance: 10 Milliohms Max.  
 Insulation Resistance: 1000 Megaohms Min.  
 Withstanding Voltage: 1000V AC/Minute  
 Contact: Brass, Tin Plated  
 Insulator: PA66(UL94V-0), White  
 RoHS Compliant

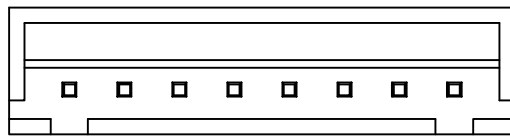

△

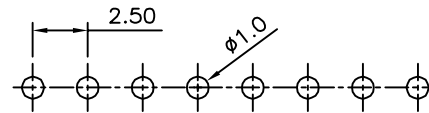

Recommended P.C.B. Layout

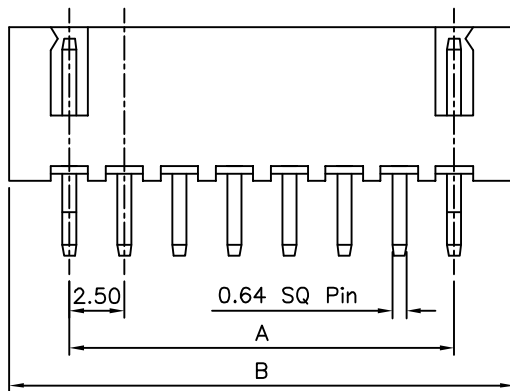

△ 3~12 Pin

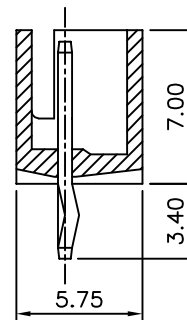

△

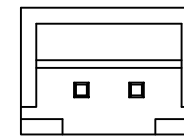

△

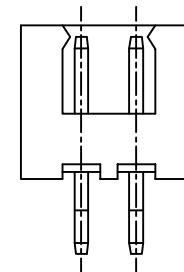

△ 2 Pin

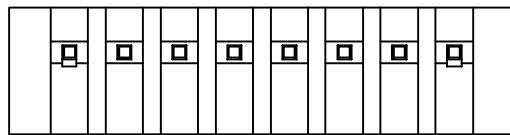

△

Pin	A	B
02	2.50	7.50
03	5.00	10.00
04	7.50	12.50
05	10.00	15.00
06	12.50	17.50
07	15.00	20.00
08	17.50	22.50
09	20.00	25.00
10	22.50	27.50
11	25.00	30.00
12	27.50	32.50



DRAWING No.

01600

SCALE NONE

APPROVED BY

EMILY

CHECKED BY

HZF

DRAWING BY

WZL

REV. A1

UNLESS OTHERWISE SPECIFIED TOLERANCES ARE

.X ±0.35

.XX ±0.25

UNIT mm



△ A1 Modify Data HZF 02/23/2011

△ A0 NEW RELEASE HZF 08/24/2009

NO. REV. REVISIONS CHK DATE